

Recommended for approval as
 and in accordance with the
 provisions of the Maharashtra
 Town Planning Act, 1962
 and the Maharashtra
 Town Planning (Amendment)
 Act, 1971.

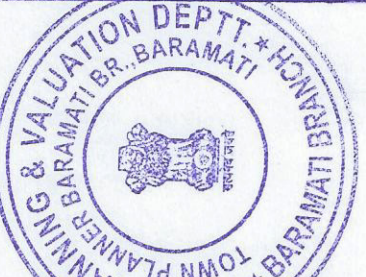

APPROVED FOR THE OFFICE
 OF THE TOWN PLANNING
 OFFICER, BARAMATI
 PUNE.

APPROVED FOR THE OFFICE
 OF THE TOWN PLANNING
 OFFICER, BARAMATI
 PUNE.

APPROVED FOR THE OFFICE
 OF THE TOWN PLANNING
 OFFICER, BARAMATI
 PUNE.

APPROVED FOR THE OFFICE
 OF THE TOWN PLANNING
 OFFICER, BARAMATI
 PUNE.

APPROVED FOR THE OFFICE
 OF THE TOWN PLANNING
 OFFICER, BARAMATI
 PUNE.

APPROVED FOR THE OFFICE
 OF THE TOWN PLANNING
 OFFICER, BARAMATI
 PUNE.

APPROVED FOR THE OFFICE
 OF THE TOWN PLANNING
 OFFICER, BARAMATI
 PUNE.

APPROVED FOR THE OFFICE
 OF THE TOWN PLANNING
 OFFICER, BARAMATI
 PUNE.

APPROVED FOR THE OFFICE
 OF THE TOWN PLANNING
 OFFICER, BARAMATI
 PUNE.

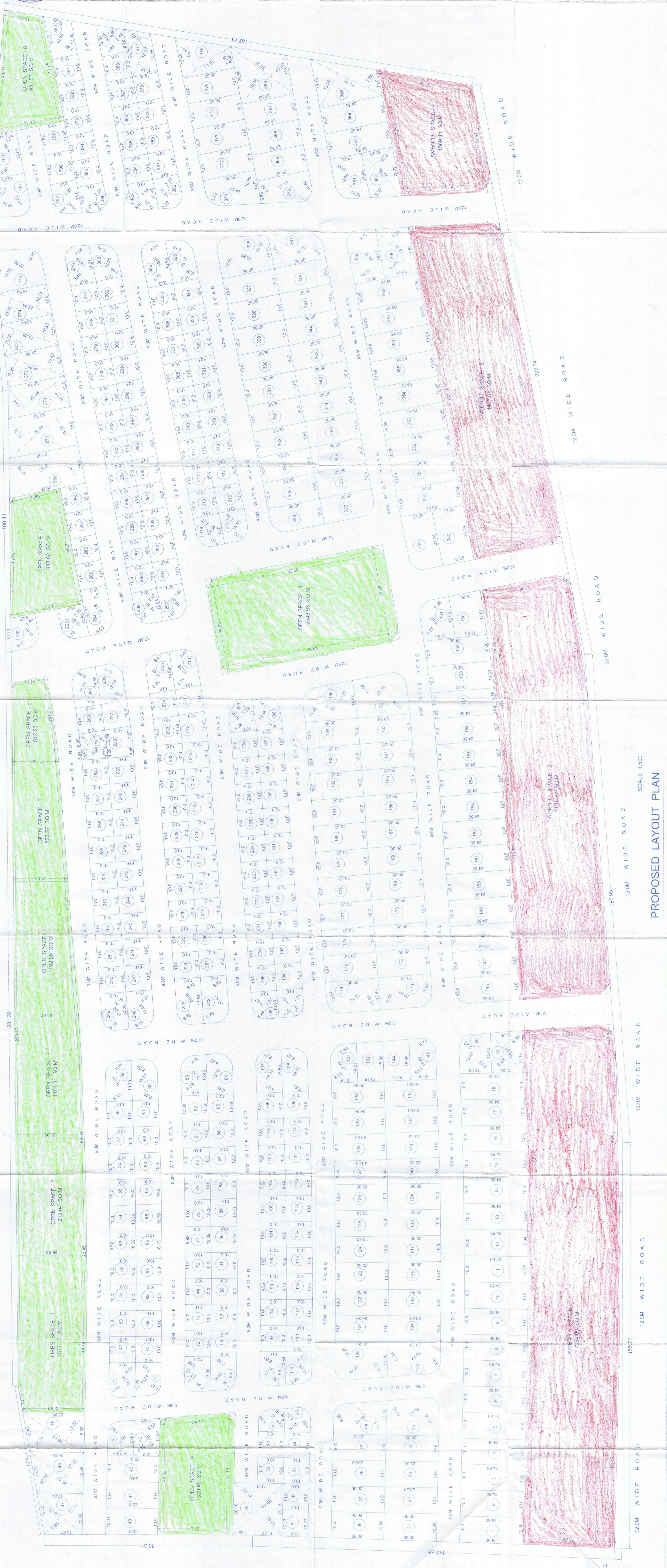

AREA STATEMENT

- AREA OF PLOT AS PER 712 = 1237R
- DEDUCTION FOR:
 - A) AREA UNDER ROAD WIDENING = 296.37
 - B) NET GROSS PLOT AREA = 11.2A
- NET GROSS PLOT AREA = 12440.63
- DEDUCTION FOR:
 - A) REQUIRED OPEN SPACE 10% OF 3 = 12440.36
 - B) PROVIDED OPEN SPACE 10% OF 3 = 12441.67
 - C) REQUIRED AMENITY SPACE 15% OF 3 = 16660.54
 - D) PROVIDED AMENITY SPACE = 16666.79
 - E) INTERNAL ROAD = 31010.19
 - F) TOTAL (B + D + E) = 62718.65
- NET AREA OF PLOT (3.4F) = 62718.65
- NET AREA OF PLOTS FOR F.S.I CALCULATION 80% X (3.4D) = 95183.16
- PERMISSIBLE F.S.I FACTOR FOR LAYOUT PLOTS (65) = 0.90 X (12440.63 - 16666.79) = 85103.15
- PERMISSIBLE BUILDUP AREA ON NORMAL BASIS FOR PATA = 44073.32

LEGEND

MAIN PLOT BOUNDARY SHOWN BY

OPEN SPACE SHOWN BY

AMENITY SPACE SHOWN BY

ROAD WIDENING SHOWN BY

AS PER POWER OF ATTORNEY -
 NAME AND SIGN
 SHRI. PRAKASH BALASAHEB CHAVAN
 SHRI. SACHIN RAGHUNATH BHOSALE

NAME OF OWNER

- KESHAV SARJERAO JAGTAP
- VISHAL KESHAVRAO JAGTAP
- AMBARAS MARUTRAO JAGTAP
- ANIL KRISHNARAO JAGTAP
- SHANKAR NIVRUTTI TAWARE
- DILIP NIVRUTTI TAWARE
- ASHOK NIVRUTTI TAWARE
- DADASO KALYANRAO MARUTI PANCHAGANE

PROJECT TENTATIVE RESIDENTIAL LAYOUT IS AT GAT NO. 23005
 MALEGAON BK. TAL. BARAMATI, DIST. PUNE.

SCALE: 1:1000

SANJAYS KADAM

ALL DIMENSION IN METRE

PROJECT

PROJECT TENTATIVE RESIDENTIAL LAYOUT IS AT GAT NO. 23005
 MALEGAON BK. TAL. BARAMATI, DIST. PUNE.

SCALE: 1:1000

SANJAYS KADAM

ALL DIMENSION IN METRE

BARAMATI MUNICIPAL LICENCE NO. LE/00086/2015-16
 BE (CIVIL), F.I.V. AMLE (INDIA)
 CHARTERED ENGINEER - AM08170399, APPROVED VALUER - F13100
 ARCHITECT - WHEEL COLONY BARAMATI
 PHONE NO. 955979179

DATE

Stamp

Sanjays Kadam
 B.E. (CIVIL), P.V., A.MLE (INDIA)
 Chartered Engineer (Licence) - AM08170399

DRG. NO.

PROPOSED LAYOUT PLAN

SCALE 1:500

ROAD WIDENING LINE